

ECON ROUND SERIES

Important Notes and Safety Instructions

Please read installation manual carefully before commencement of installation.

Before carrying out any installation, ensure all power is switched off and disconnected from the main power supply.

This product must be installed by a qualified installer under local and national regulations.

The light source of the luminaire is not replaceable. When the light source reaches its end of life, the whole luminaire shall be replaced.

Product Warranty

For any warranty claim, a valid Proof of Purchase is required.

Glos does not warrant any claim based on defects or damage caused by improper installation, improper operation, wrongful cleaning agents that deteriorate the surface appearance, force majeure, and/or modifications made by purchaser or third party. For warranty duration, please contact your service agent or GLOS sales representative for more information.

Cleaning and Care

Before cleaning, disconnect the luminaire from main supply and allow it to cool. Clean external surface using lint free cloth with alcohol-free and non-abrasive cleaning agent.

Corrosion Protection

Do not expose luminaire to corrosive agents (e.g salt, acid, chemical & cleaning agents) during installation or cleaning, it will cause corrosion on the surface of the luminaire.

Ambient Condition

LED luminaires performs best in an ambient temperature $<25^{\circ}\text{C}$ ($\pm 5^{\circ}\text{C}$). High ambient temperature can reduce the lifespan and efficiency of LED module and driver.

Dimming

Before installation of luminaire, ensure control gear, LED and dimmer combination are compatible. Improper or unsuitable use of dimmer can cause damage to the components.

Sizing Variation

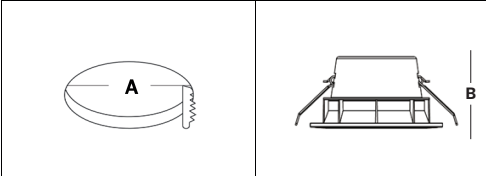
|  | | |
|---|-----|-----|
| Product | A | B |
| ECON ROUND-1 | 100 | 55 |
| ECON ROUND-2 | 125 | 70 |
| ECON ROUND-3 | 150 | 83 |
| ECON ROUND-4 | 200 | 89 |
| ECON ROUND-5 | 200 | 100 |
| ECON ROUND-5 MAX | 200 | 100 |

All measurements are in millimeters.

Installation Instructions

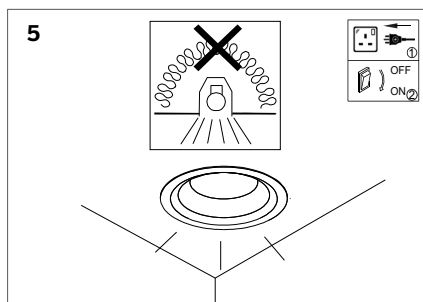
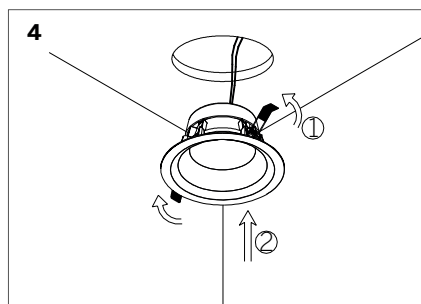
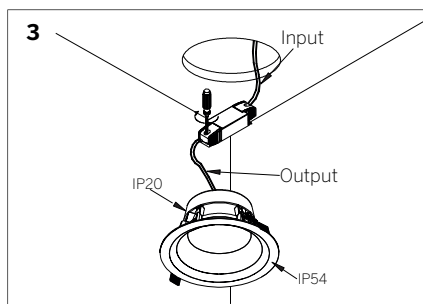
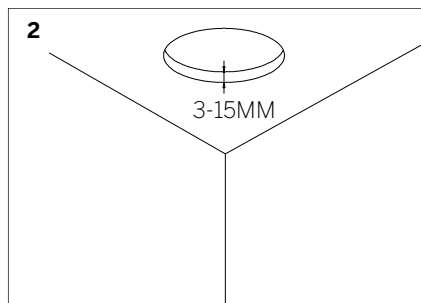
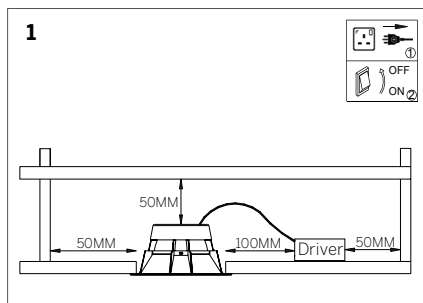

- 1** Before installation or servicing, turn off and disconnect from main power supply. Ensure that there is 50-100mm clearance for LED driver and luminaire after installation.
- 2** Fixed luminaire can accommodate a ceiling thickness of 3-15mm. Cut out a round hole according to fixture cut out.
- 3** Connect main incoming supply to LED driver and luminaire to LED driver. Place the LED driver into the false ceiling; Avoid placing the LED driver close to a heat source.
- 4** Insert the LED luminaire into the hole by engaging the torsion spring clips upward away from the trim. Ensure the torsion spring clips are fully engaged in the ceiling and the luminaire is fully flush with the ceiling.
- 5** Luminaire and LED driver are not suitable for covering with the thermally insulating material. Restore power.